

Bi-directional in-line detonation flame arrester

KITO EFA-Det4-IIA-.../...-...

KITO EFA-Det4-IIA-.../...-...-T (-TT)

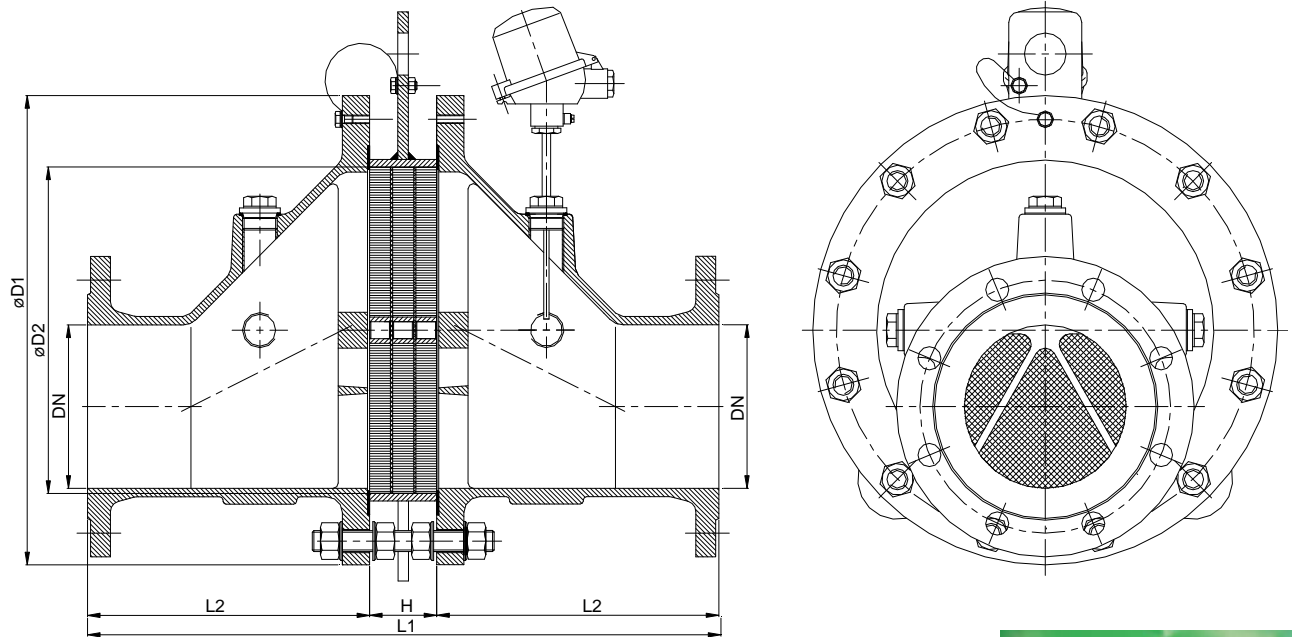
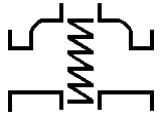

| Größe | DN | ANSI | D1 | D2 | L1 | H | L2 | p _{max.} | kg* |
|-------|-----|--------|------|-----|------|-----|-----|-------------------|-----|
| 65 | 25 | 1" | 155 | 70 | 304 | 64 | 120 | 2,5 | 12 |
| | 32 | 1 1/4" | | | | | | | |
| 100 | 40 | 1 1/2" | 220 | 106 | 354 | 64 | 145 | 2,5 | 26 |
| | 50 | 2" | | | | | | | 26 |
| 150 | 50 | 2" | 285 | 159 | 414 | 64 | 175 | 2,5 | 45 |
| | 65 | 2 1/2" | | | | | | | |
| | 80 | 3" | | | | | | | 50 |
| 200 | 80 | 3" | 340 | 206 | 464 | 64 | 200 | 2,5 | 65 |
| | 100 | 4" | | | | | | | |
| 300 | 100 | 4" | 445 | 308 | 626 | 86 | 270 | 2,5 | |
| | 125 | 5" | | | | | | | |
| | 150 | 6" | | | | | | | 132 |
| 400 | 150 | 6" | 565 | 388 | 716 | 86 | 315 | 2,0 | |
| | 200 | 8" | | | | | | | |
| 500 | 200 | 8" | 670 | 485 | 846 | 86 | 380 | 2,0 | |
| | 250 | 10" | | | | | | | |
| 600 | 250 | 10" | 780 | 584 | 986 | 86 | 450 | 2,0 | |
| | 300 | 12" | | | | | | | |
| 800 | 350 | 14" | 1015 | 810 | 1350 | 110 | 620 | 2,0 | |
| | 400 | 16" | | | | | | | |



Type examination certificate to ISO 16852 and EN 12874

CE -designation in accordance to ATEX-Guideline 94/9/EG

Dimensions in mm

* weights refer to the standard design

Design subject to change

For performance curves see diagram: G 0.23 N

Standard design

housing : cast steel 1.0619,
stainless cast steel 1.4408
gasket : HD 3822, PTFE
casing for grid : 1.0305, stainless steel mat. no.
1.4571, 1.4581
grid : stainless steel mat. no. 1.4310, 1.4571,
strip thickness 0.15 mm
bolts/nuts : galvanized steel, SS
temperature sensor : PT 100 (option); connection 3/8"
flange connection : DIN 1092-1 PN 10/16 Form B1,
ANSI 150 lbs. RF

Example for orders :

KITO EFA-Det4-IIA-100/40-2.5-T

(design p = 2.5 bar, with thermo couple element)

Application

For installation into pipelines to the protection of containers and components against stable detonation of flammable liquids and gases. Tested and approved as detonation flame arrester **type 4**. Approved for all substances of explosion groups IIA1 to IIA with a maximum experimental safe gap (MESG) > 0.9 mm. Bi-directionally working in pipelines, whereby an operating pressure of 2.5 bar abs. up to NG 300, p_{max} = 2.0 bar abs. from NG 400 and an operating temperature of 60°C must not be exceeded. The installation of the detonation flame arrester into horizontal and vertical pipelines is permissible. Provided with one or two temperature sensors (PT 100) the armature is certified against short time burning from one or both sides. If only one thermal sensor is attached, it must be installed into that part of the body from which a fire is expected.

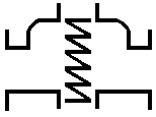

Performance Curves

KITO EFA-Det4-IIA-.../...-... KITO EFA-Det4-IIA-.../...-...-T (-TT)

The flow capacity V refers to a density of air with $\rho = 1.29 \text{ kg/m}^3$ at $T = 273 \text{ K}$ and a pressure of $p = 1.013 \text{ mbar}$.
The flow capacity for gases with different densities can be calculated sufficiently accurate by the following approximation equation:

$$\dot{V} = \dot{V}_b \cdot \sqrt{\frac{\rho_b}{1.29}} \quad \text{or} \quad \dot{V}_b = \dot{V} \cdot \sqrt{\frac{1.29}{\rho_b}}$$

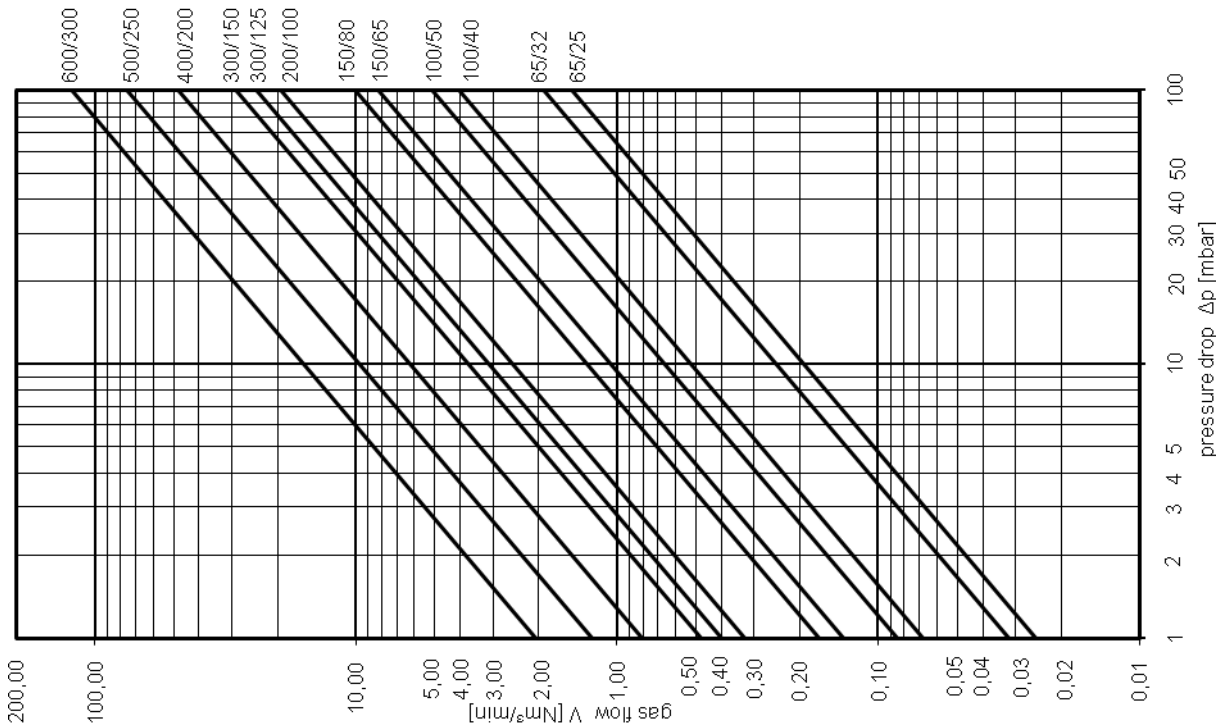
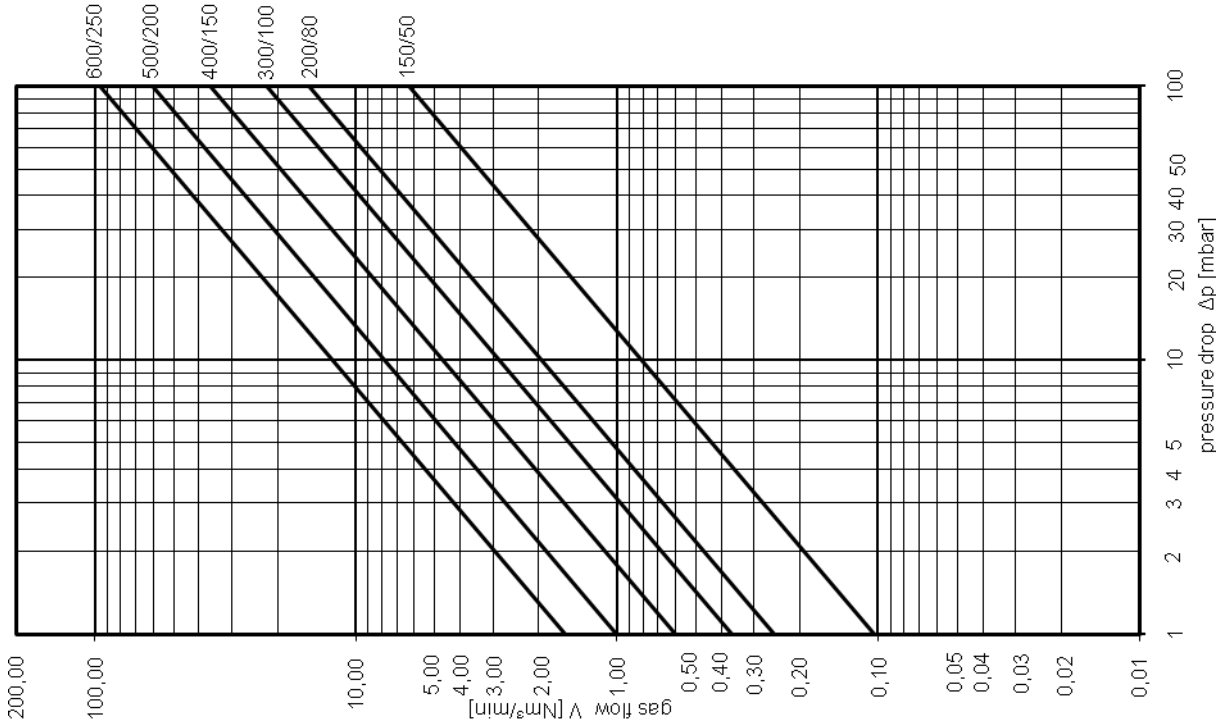

Design subject to change